



SK sub-sub-miniature switch

Technical specifications

Contact configuration	S.P.D.T.
Switching voltage max.	12 VDC
Switched current	10 mA to 100 mA
Operating force	max. 200 cN
Total travel	ca. 2,0 mm
Mechanical life	min. 500.000 operations
Electrical life (max. load)	min. 100.000 operations
Ambient temperature	-40 °C to +85 °C
Materials	
Base	PPS
Cover	PBT + ASA
Actuator	POM
Auxiliary actuator	Stainless steel
Sealing gasket	Silicone
Terminals	CuSn6 gal. Ag
Leads	Cu, Isolation PVC
Degree of protection (switch interior)	IP6K5, IP6K7 with potted leads

For detailed information and the layout of the details described above, please do not hesitate to ask for our technical specifications and drawing.

Features

- Sealed switch up to protection IP65. IP67 on request
- Smallest dimensions
- Models available up to 85 °C operating temperature
- Actuation vertically or with auxiliary actuator
- High contact stability by double redundant contact system
- High operating life
- Many connection possibilities, also with leads available on request

Dimensions in mm

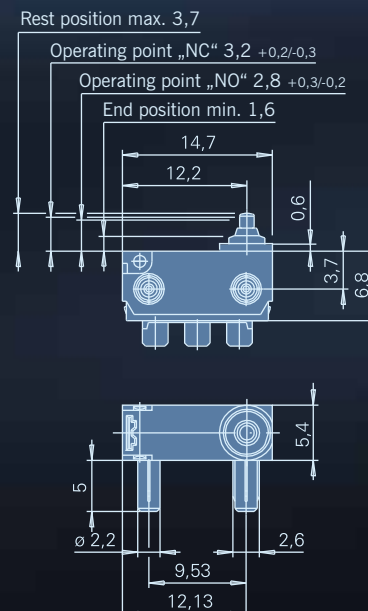



Terminals and location pins

Type of terminal	Code
Solder terminals 2,5x0,4 mm, straight, without pins	RN
Solder terminals 2,5x0,4 mm, straight, with RH pins	RR
Solder terminals 2,5x0,4 mm, straight, with LH pins	RL
PCB terminals 0,6x0,4 mm, straight, without pins	SN
PCB terminals 0,6x0,4 mm, straight, with RH pins	SR
PCB terminals 0,6x0,4 mm, straight, with LH pins	SL
PCB terminals 0,6x0,4 mm, RH-s. with RH pins	TR
PCB terminals 0,6x0,4 mm, LH-s. with LH pins	UL
500 mm leads 0,35 mm ² to underside without pins	Z3
500 mm leads 0,35 mm ² to underside with pins	Z9
500 mm leads 0,35 mm ² to underside with pins	Z6

Terminals

For SK sub-miniature switch with leads (IP67-compliant)

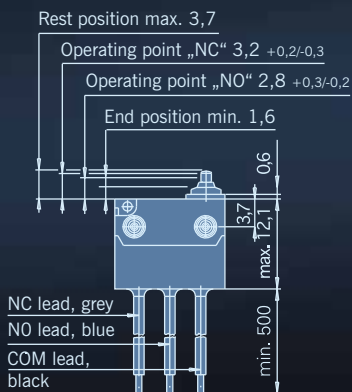

Solder terminal
2,5x0,4 mm

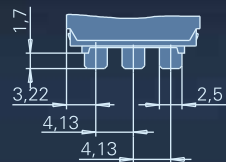

PCB terminal
0,6x0,4 mm

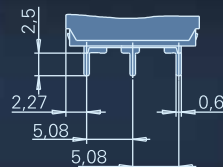

PCB terminal 0,6x0,4 mm
RH-side with location pins

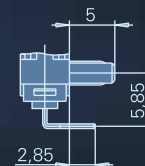

PCB terminal 0,6x0,4 mm
LH-side with location pins

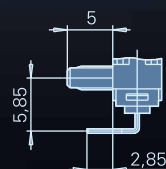

Side definition



Auxiliary actuator options

straight

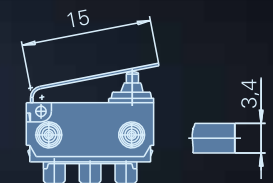

simulated roller

